

UNIT TYPE A1 & A1-P

1- BEDROOM

41 sq.m

441 sq.ft

27 Units

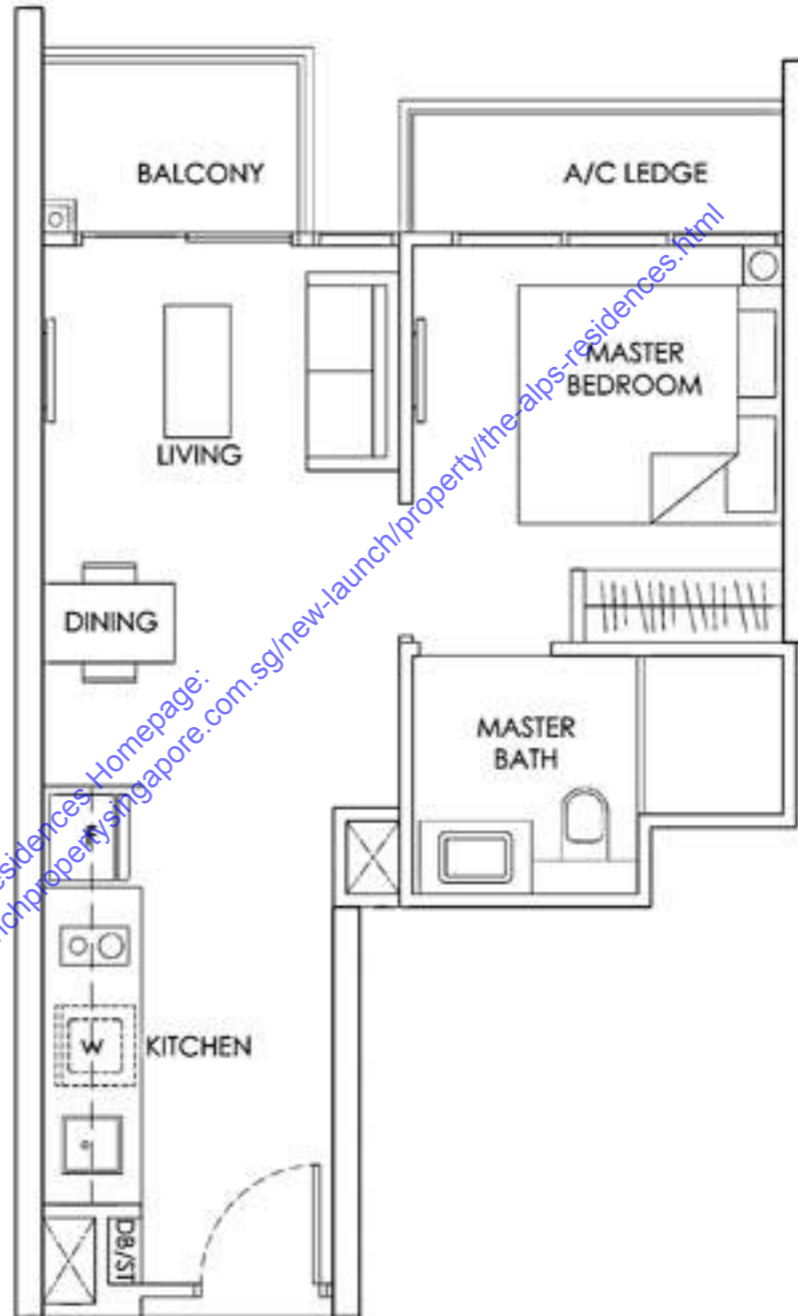

KEY PLAN

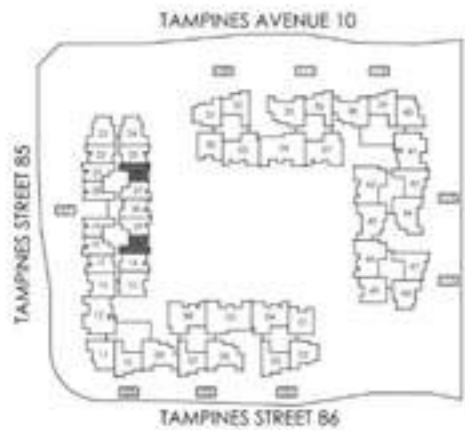

Call 9048 0660 To Enquire More!

UNIT TYPE A2 & A2-P

1- BEDROOM
43 sq.m
463 sq.ft
29 Units

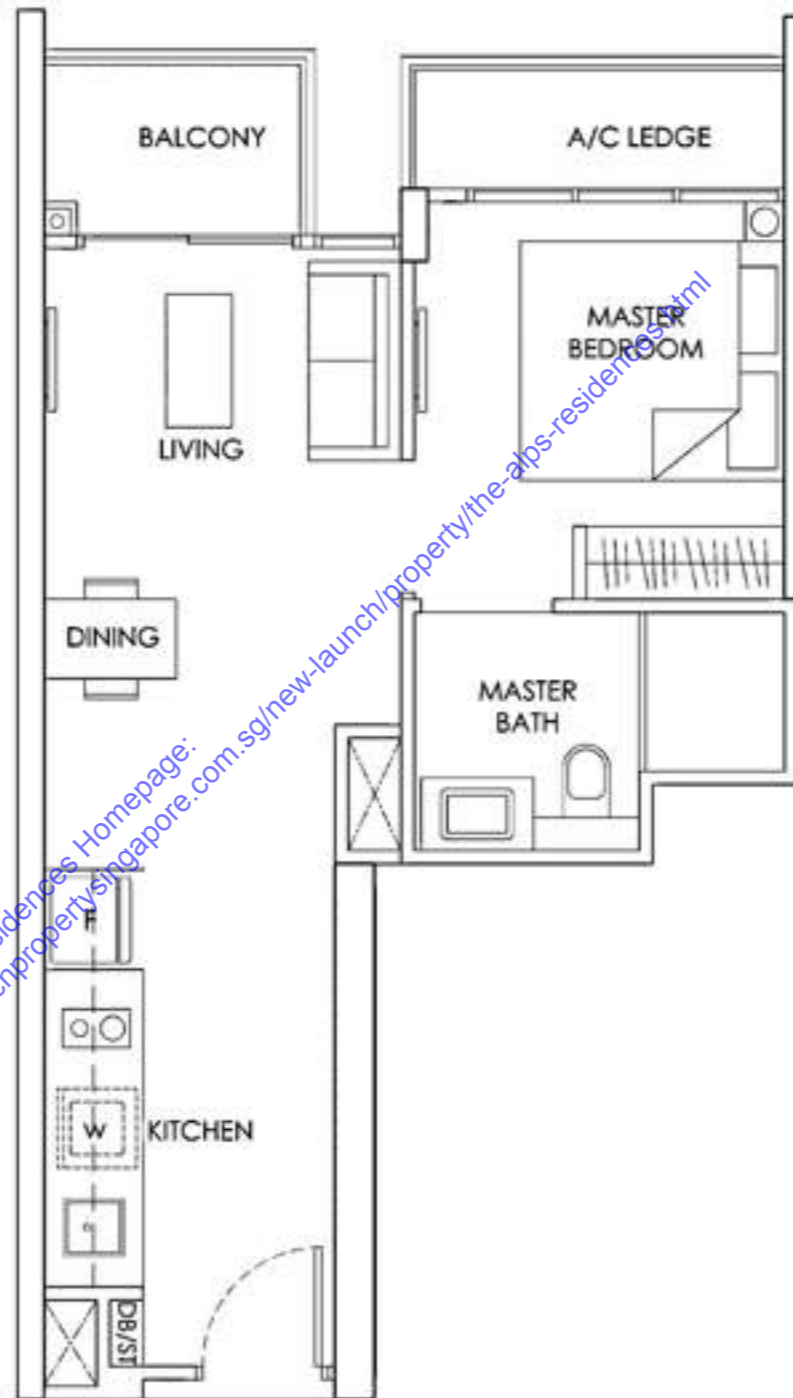

KEY PLAN

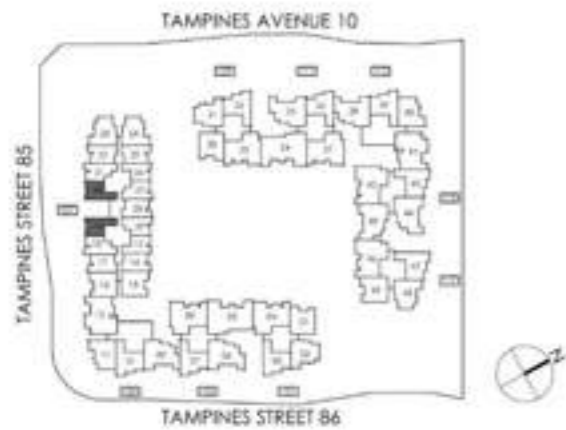

 Call 9048 0660 To Enquire More!

UNIT TYPE AS2 (SHOW UNIT) & AS2-P

1- BEDROOM + STUDY
47 sq.m
506 sq.ft
55 Units

study room sharing
bathroom with master
bedroom

potential to convert to
walk-in wardrobe or
second bedroom

compact and efficient
living/dining/kitchen area

KEY PLAN

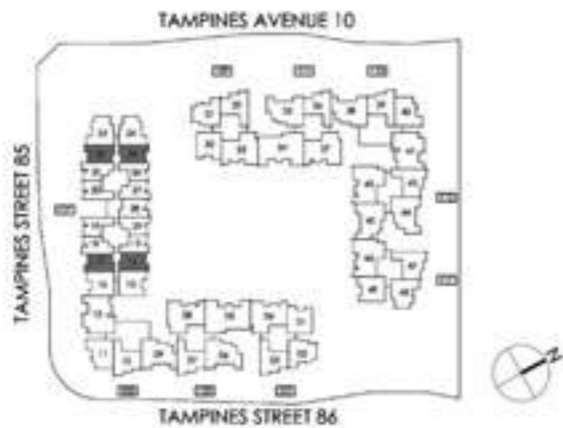

 Call 9048 0660 To Enquire More!

UNIT TYPE AS1 & AS1-P

1- BEDROOM + STUDY

46 sq.m

495 sq.ft

29 Units

study room sharing
bathroom with master
bedroom

potential to convert to
walk-in wardrobe or
second bedroom

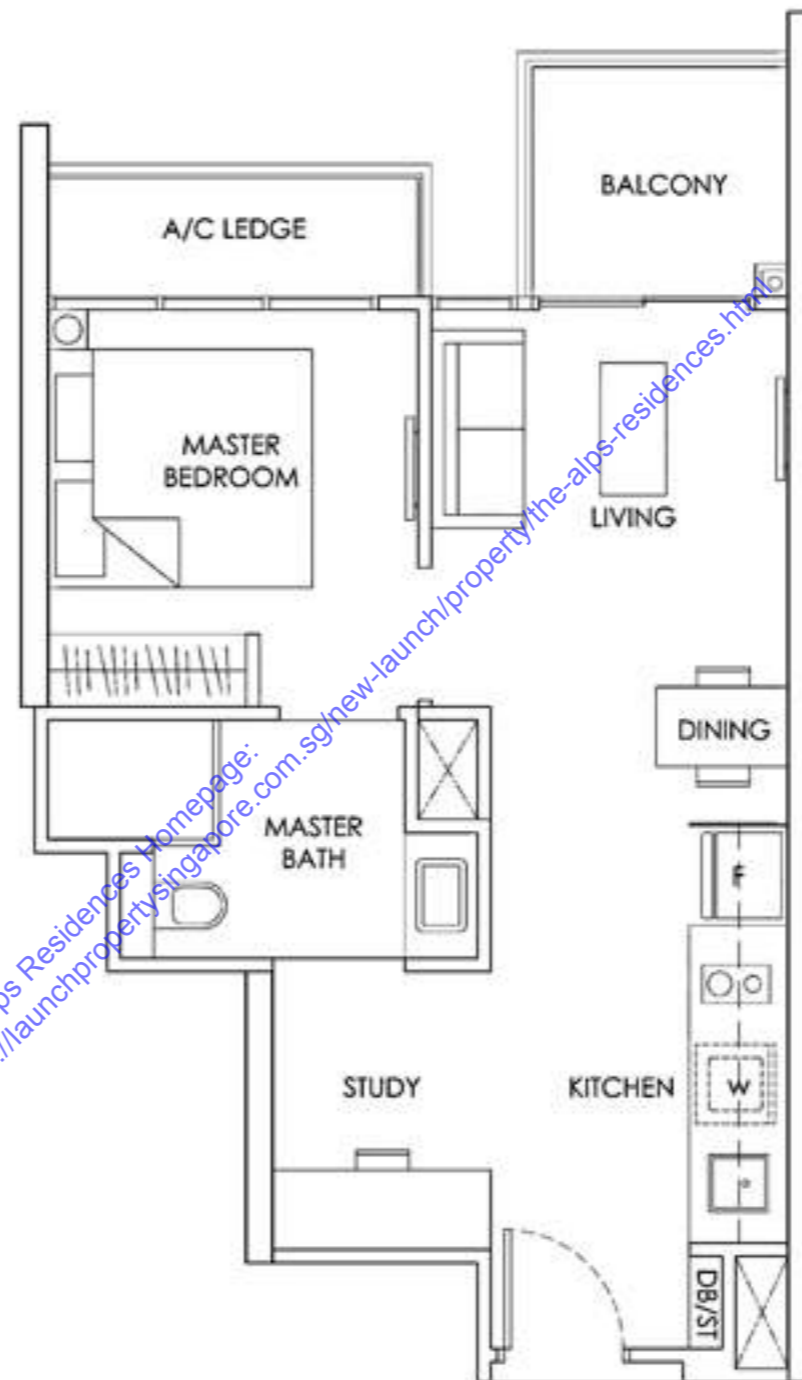

KEY PLAN

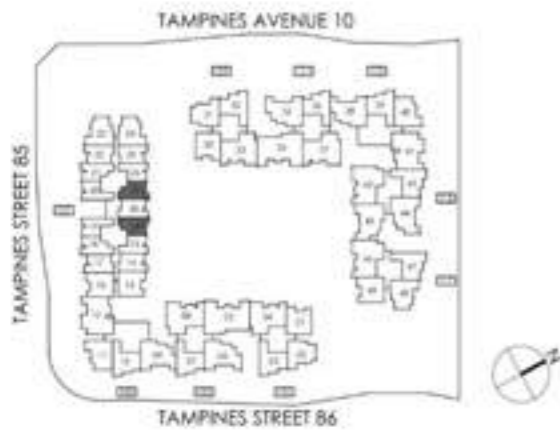

 Call 9048 0660 To Enquire More!

UNIT TYPE AS3 & AS3-P

1- BEDROOM + STUDY
47 sq.m
506 sq.ft
14 Units

study room sharing
bathroom with master
bedroom

potential to convert to
walk-in wardrobe or
second bedroom

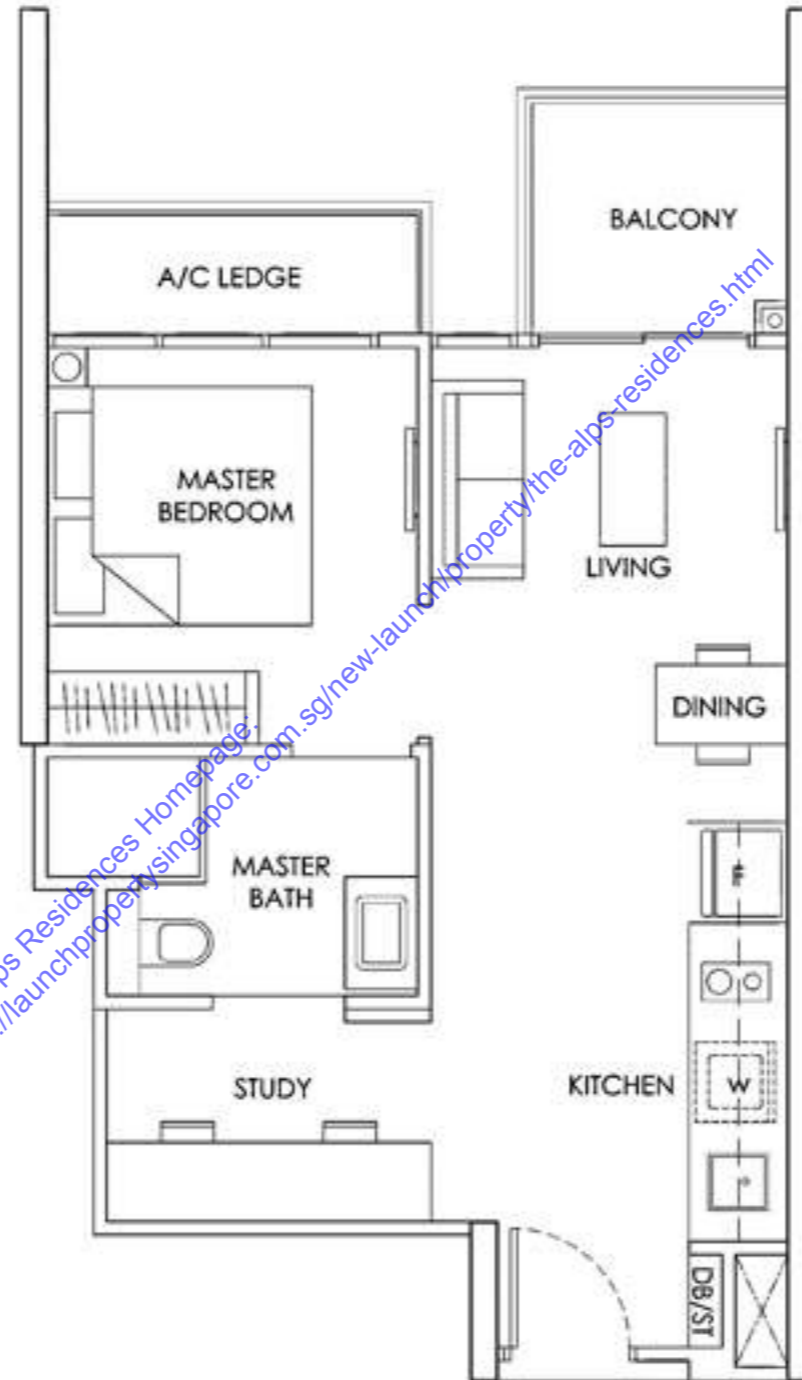

KEY PLAN

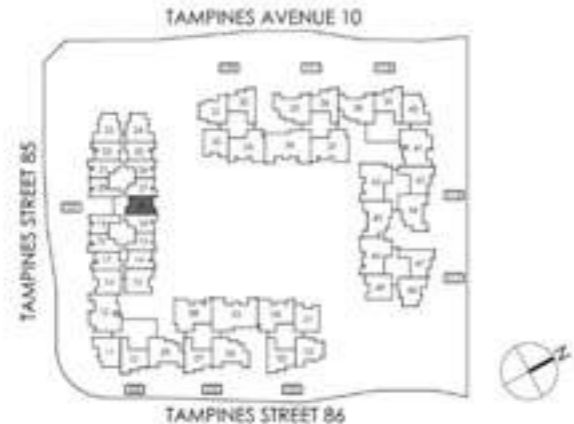

 Call 9048 0660 To Enquire More!

UNIT TYPE AS4 & AS4-P

1- BEDROOM + STUDY
47 sq.m
506 sq.ft
28 Units

study room sharing
bathroom with master
bedroom

potential to convert to
walk-in wardrobe or
second bedroom

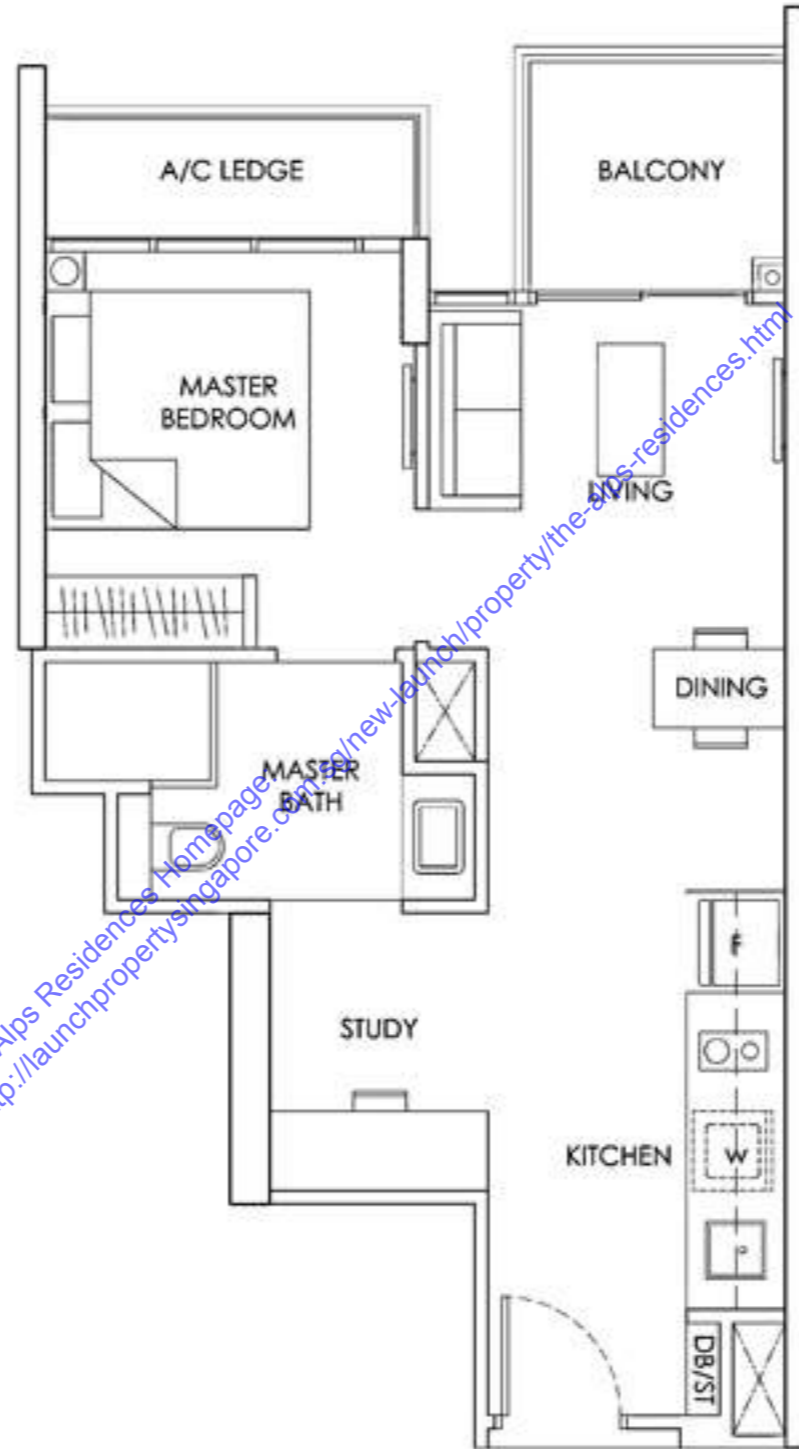

KEY PLAN

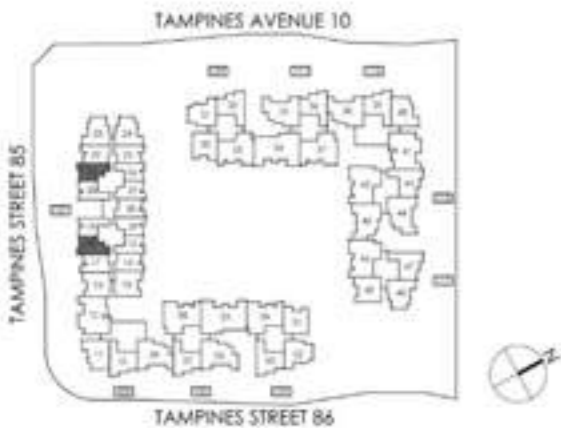

Call 9048 0660 To Enquire More!

UNIT TYPE B3 (SHOW UNIT) & B3-P

2 - BEDROOM
65 sq.m
700 sq.ft
59 Units

both bedrooms with attached bathrooms

bath 2 serves as attached bathroom and common bath

spacious living/dining/kitchen space

KEY PLAN

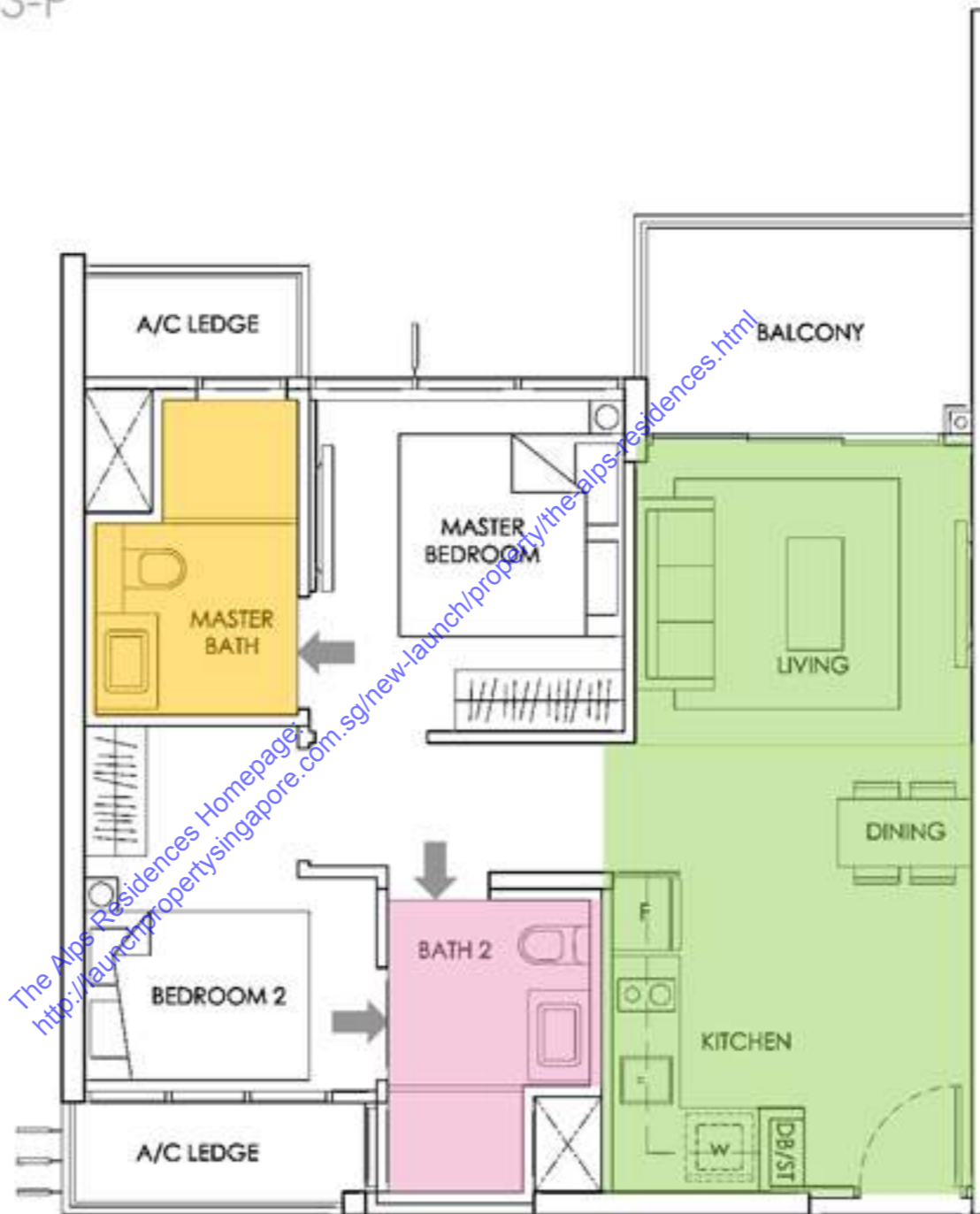

 Call 9048 0660 To Enquire More!

UNIT TYPE B1 & B1-P

2- BEDROOM

64 sq.m

689 sq.ft

43 Units

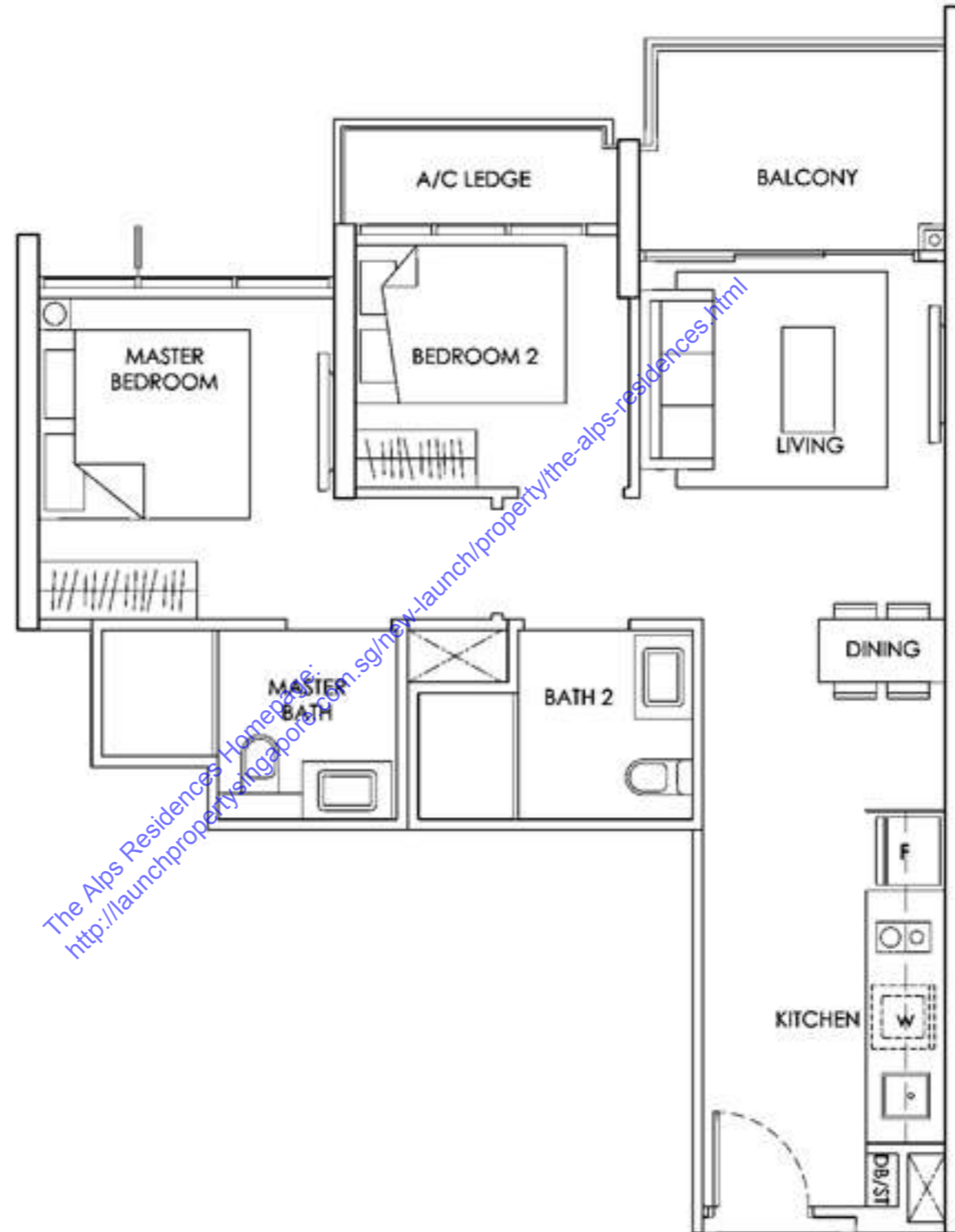

KEY PLAN

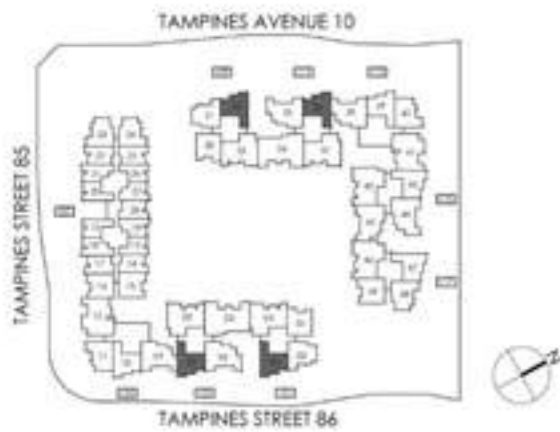

 Call 9048 0660 To Enquire More!

UNIT TYPE B2 & B2-P

2- BEDROOM

65 sq.m

700 sq.ft

51 Units

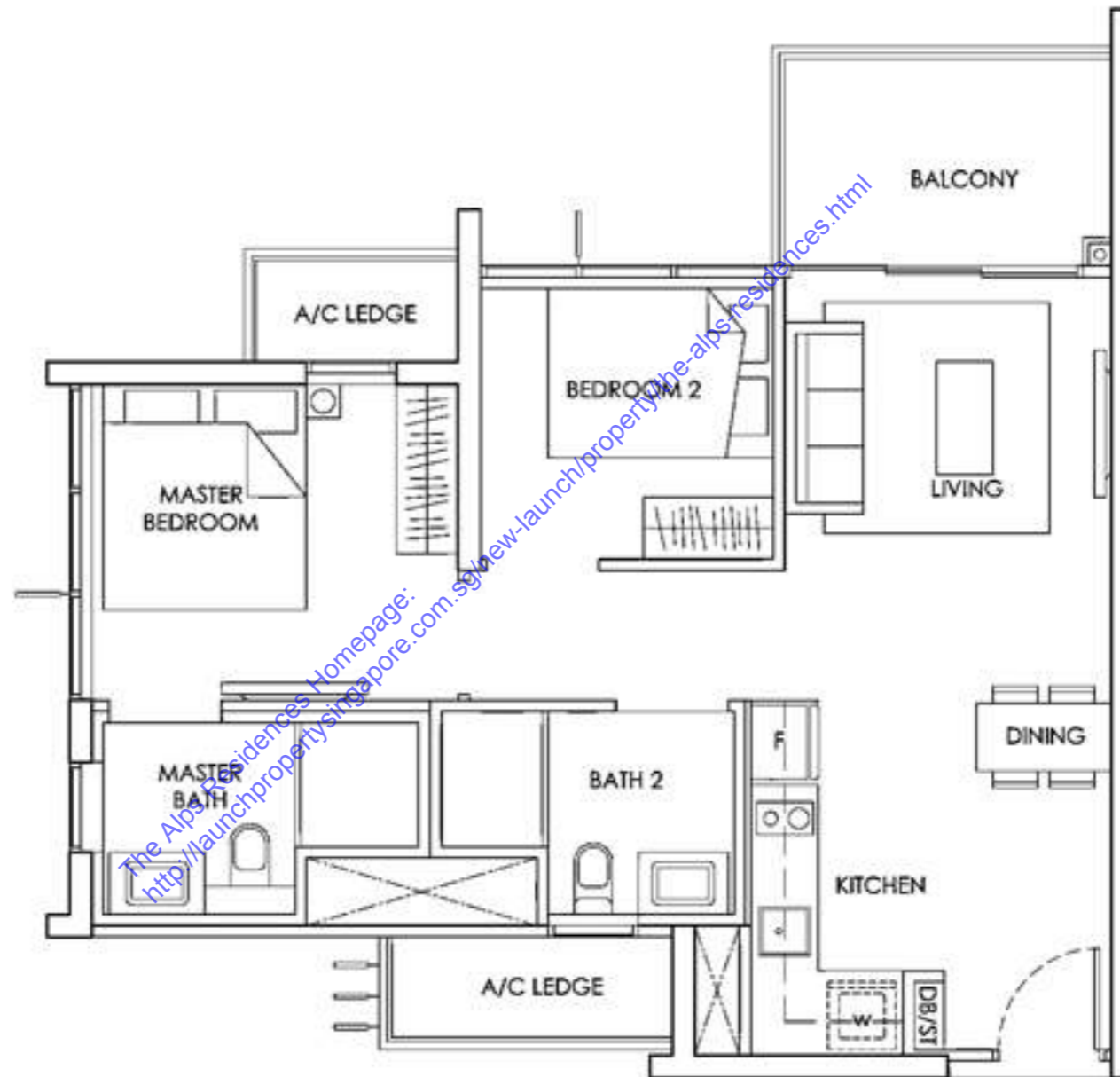

KEY PLAN

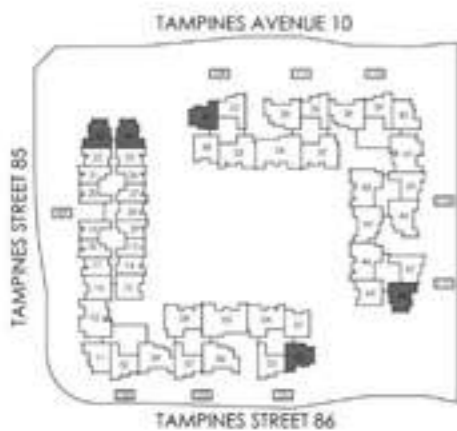

 Call 9048 0660 To Enquire More!

UNIT TYPE B4 & B4-P

2- BEDROOM

65 sq.m

700 sq.ft

30 Units

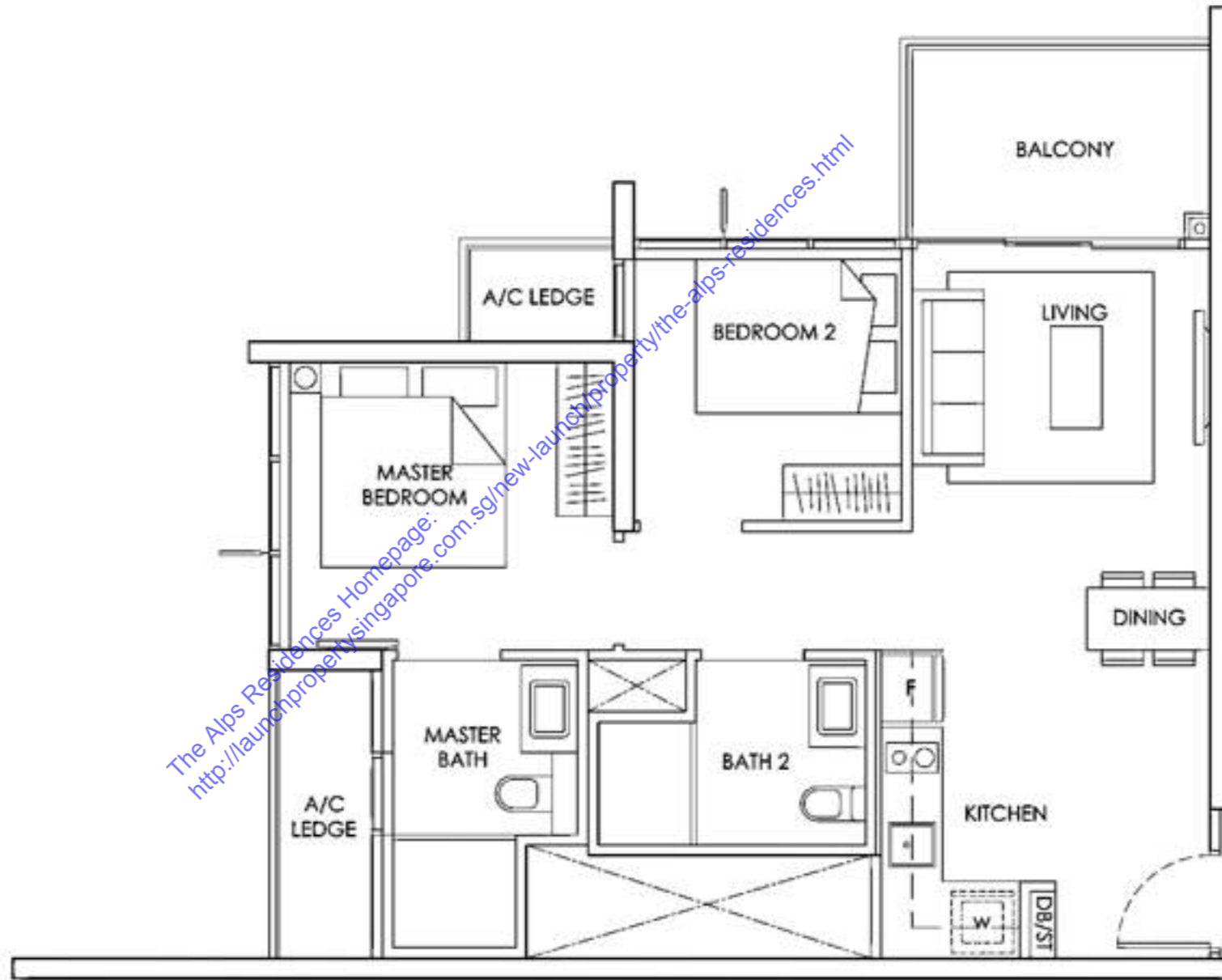

KEY PLAN

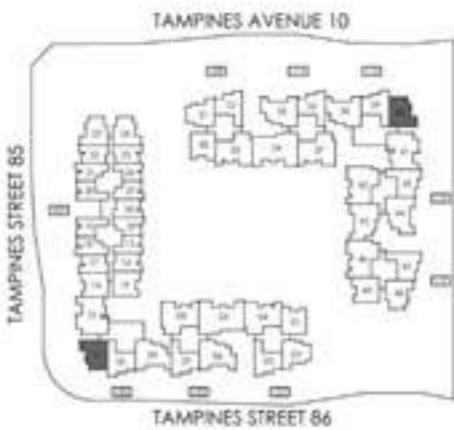

 Call 9048 0660 To Enquire More!

UNIT TYPE BS1 & BS1-P

2- BEDROOM + 1 STUDY

64 sq.m

689 sq.ft

55 Units

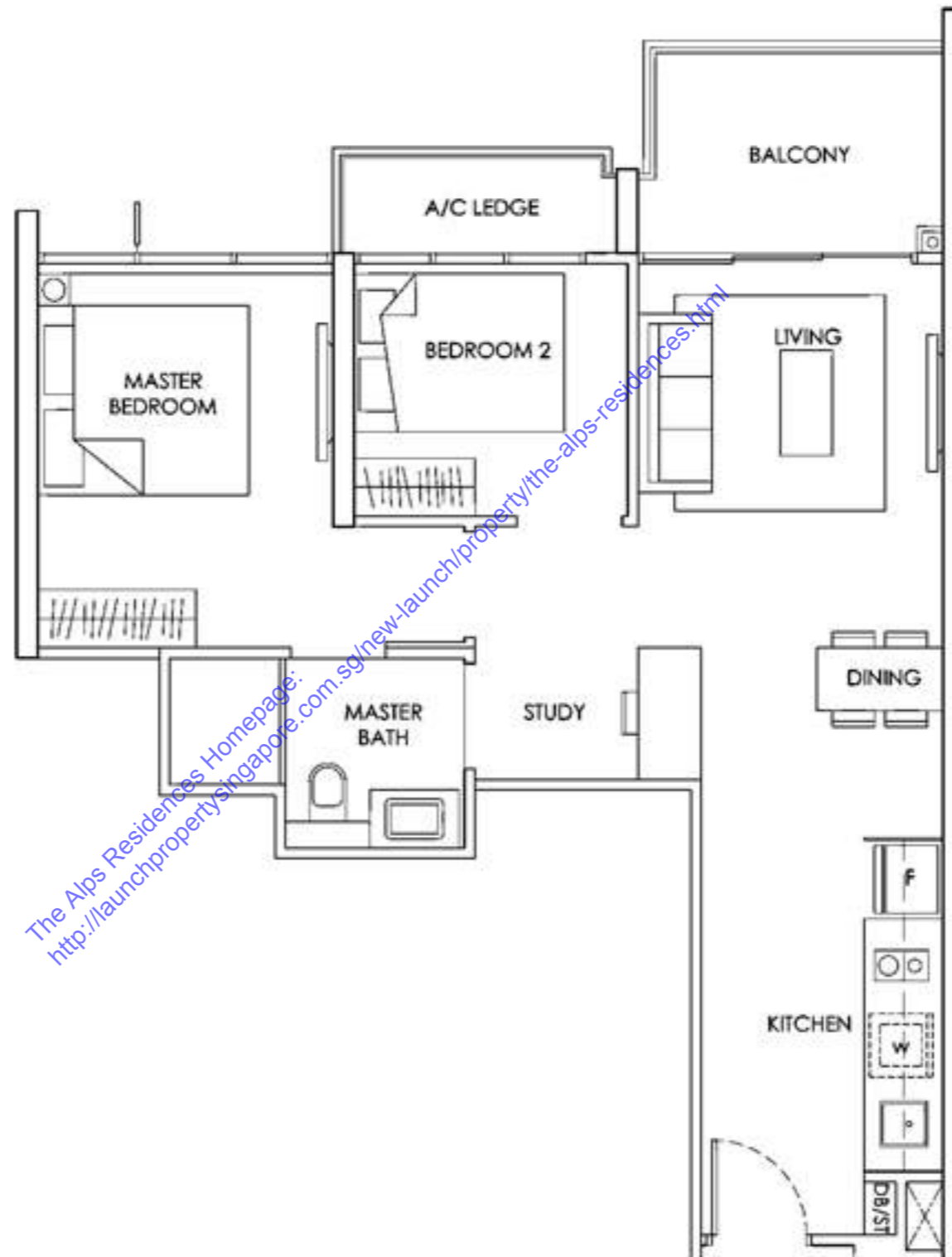

KEY PLAN

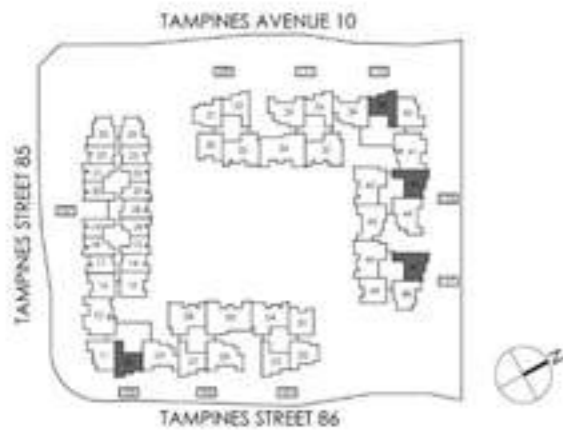

 Call 9048 0660 To Enquire More!

UNIT TYPE C2 (SHOW UNIT) & C2-P

3 - BEDROOM
99 sq.m
1066 sq.ft
69 Units

kitchen next to living room sharing the same balcony creates a unique lifestyle space

spacious living/dinning room

semi-open kitchen to enhance spatial perception



KEY PLAN

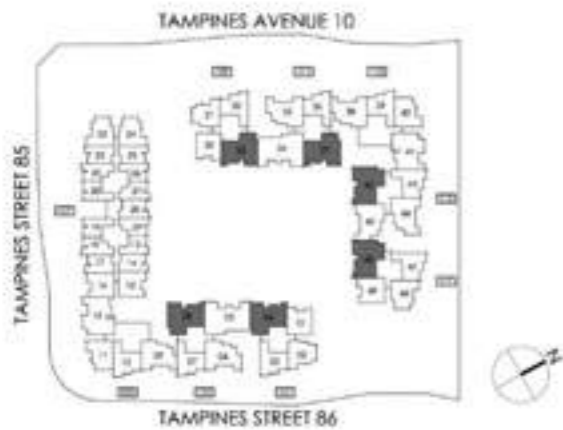

 Call 9048 0660 To Enquire More!

UNIT TYPE C3 & C3-P

3- BEDROOM
101 sq.m
1,087 sq.ft
30 Units

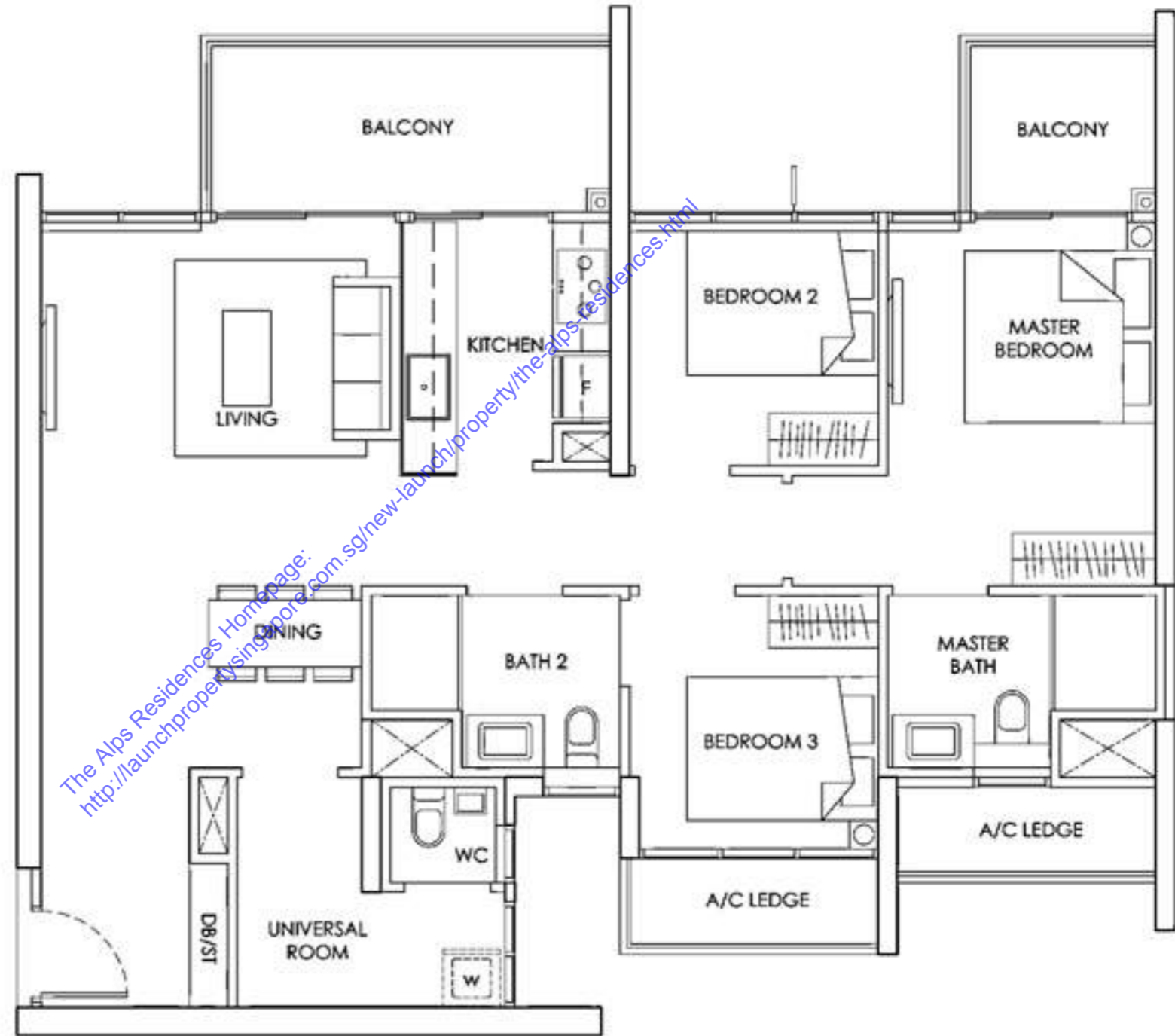

KEY PLAN

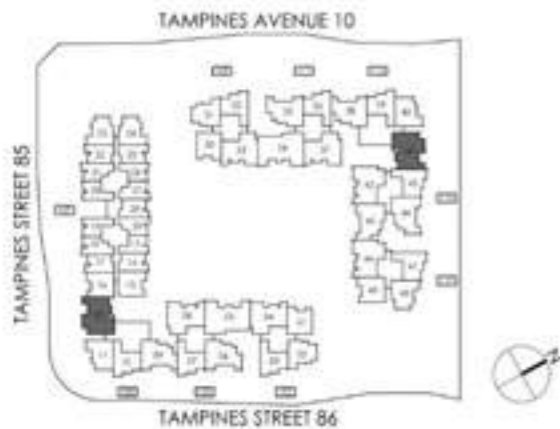

 Call 9048 0660 To Enquire More!

UNIT TYPE C1 & C1-P

3 - BEDROOM
87 sq.m
936 sq.ft
79 Units

- spacious living/dinning room
- vision panel connecting to dining

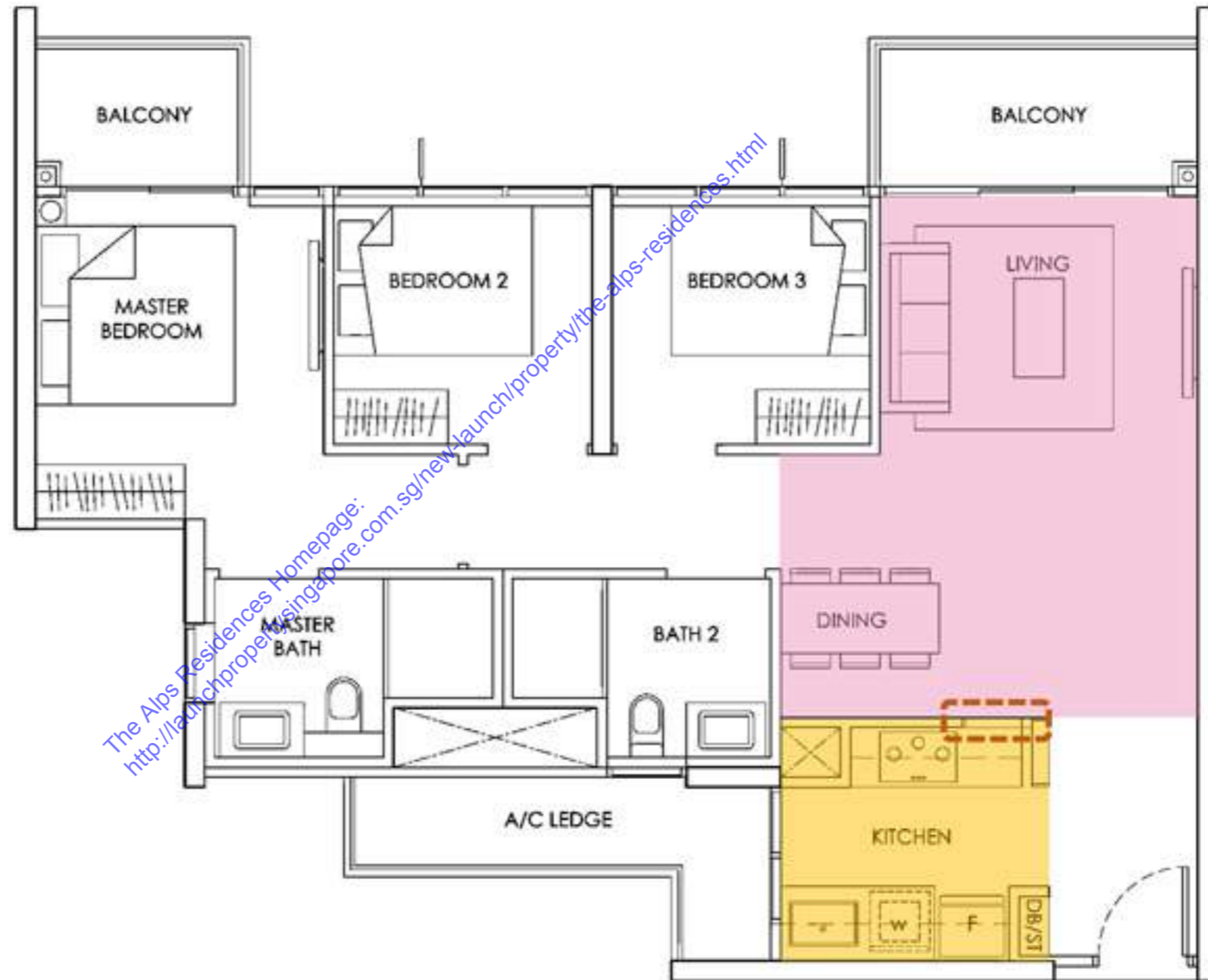

KEY PLAN

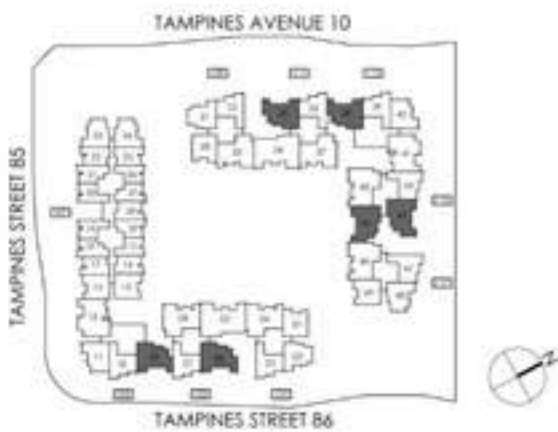

 Call 9048 0660 To Enquire More!

UNIT TYPE D1 & D1-P

4 - BEDROOM
131 sq.m
1,410 sq.ft
22 Units

- dry kitchen
- spacious living/dinning room
- all bedrooms with attached bathrooms:



KEY PLAN

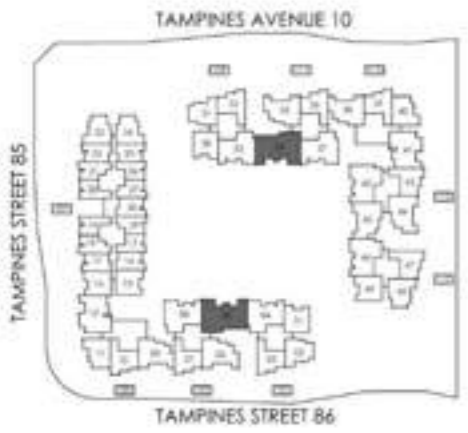

 Call 9048 0660 To Enquire More!

UNIT TYPE PH4

5 - BEDROOM
231 sq.m
2,486 sq.ft
2 Units

- spacious living/dining room
- study and powder room to serve living/dining
- all bedrooms with attached bathroom
- spacious master bedroom with walk-in wardrobe and living area

KEY PLAN

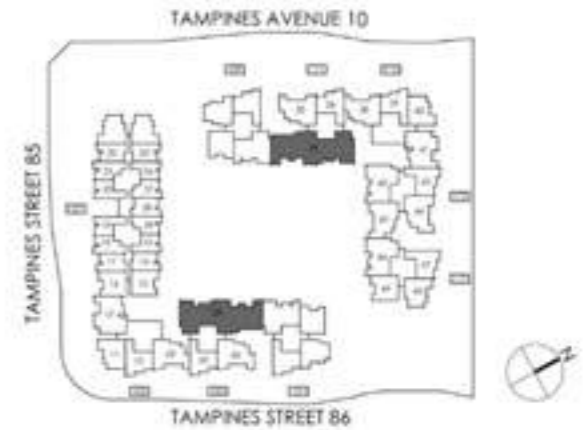

Call 9048 0660 To Enquire More!

UNIT TYPE PH1

4 - BEDROOM
155 sq.m
1,688 sq.ft
1 Unit

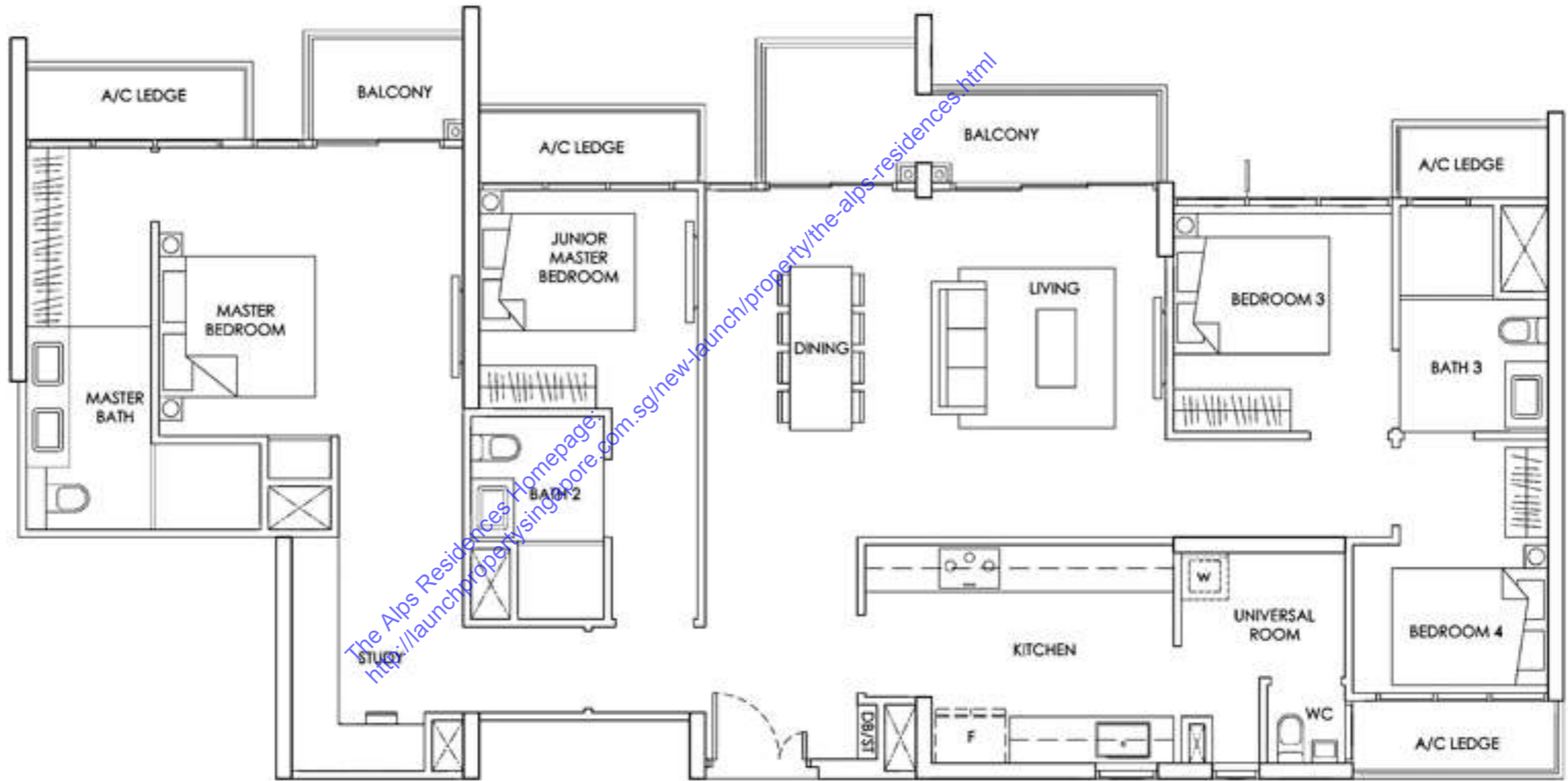

KEY PLAN

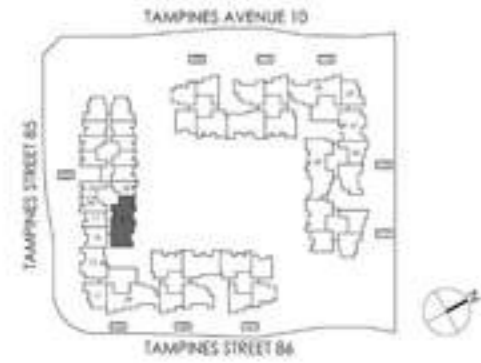

 Call 9048 0660 To Enquire More!

UNIT TYPE PH2

4 - BEDROOM
165 sq.m
1,766 sq.ft
2 Units

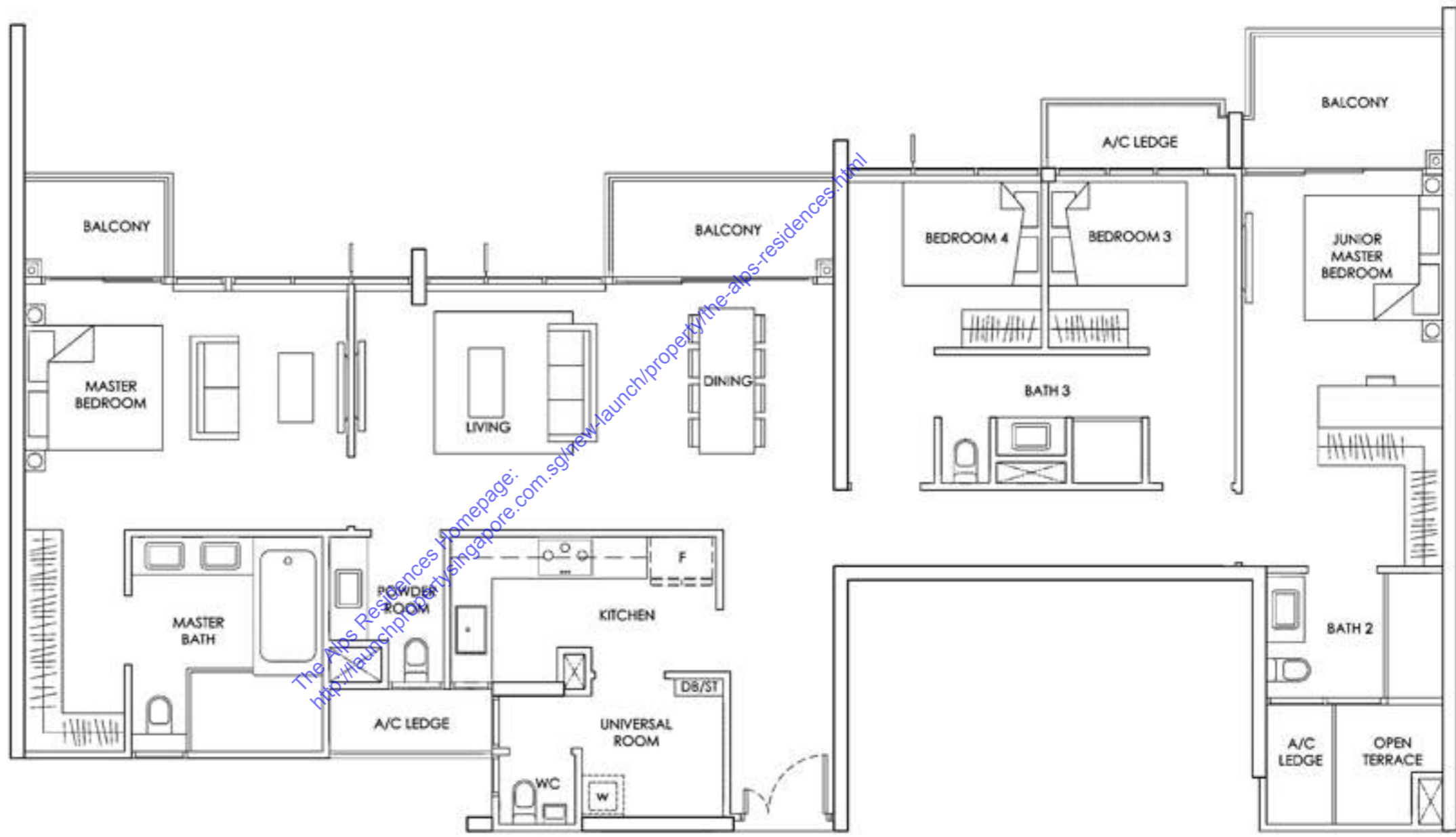

KEY PLAN



 Call 9048 0660 To Enquire More!

UNIT TYPE PH3

4 - BEDROOM
194 sq.m
2,088 sq.ft
1 Unit

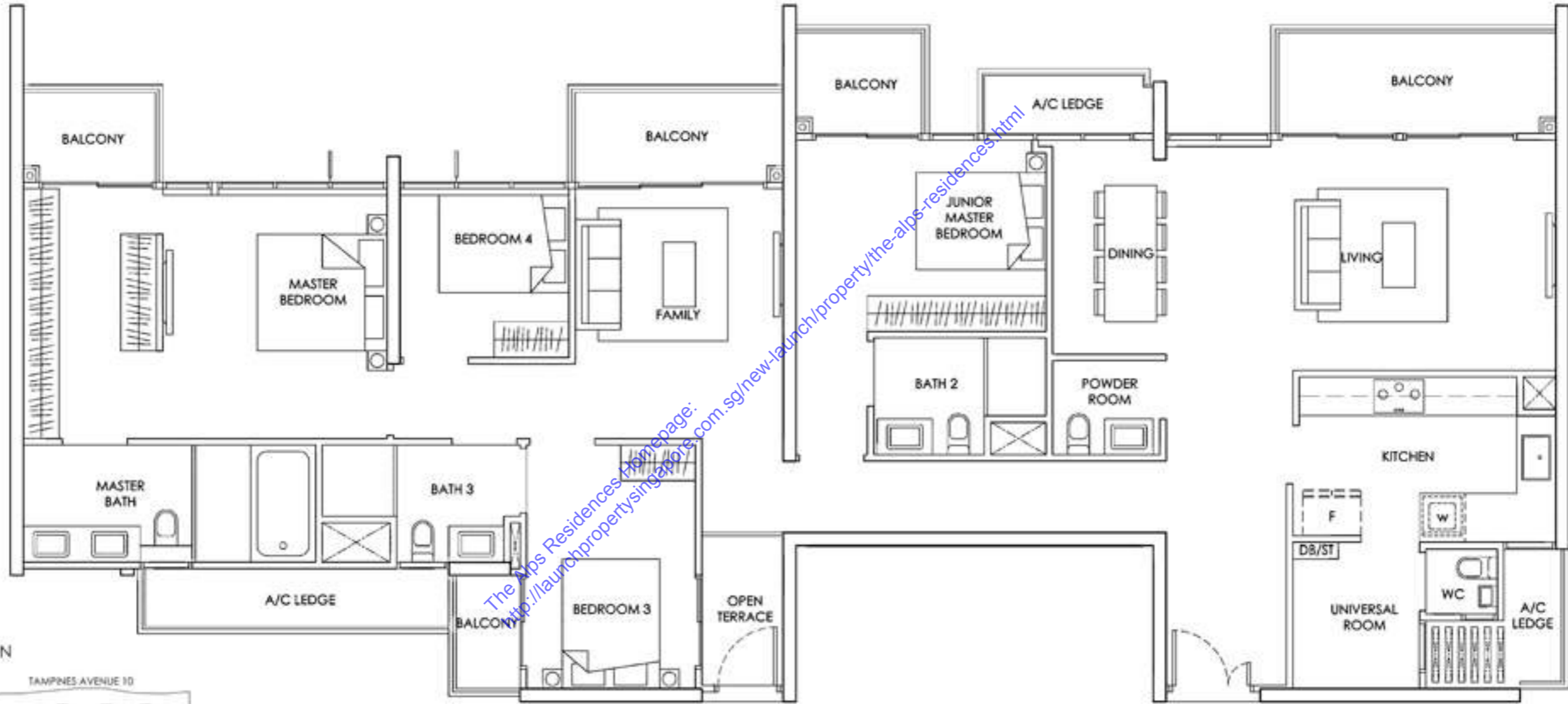

KEY PLAN

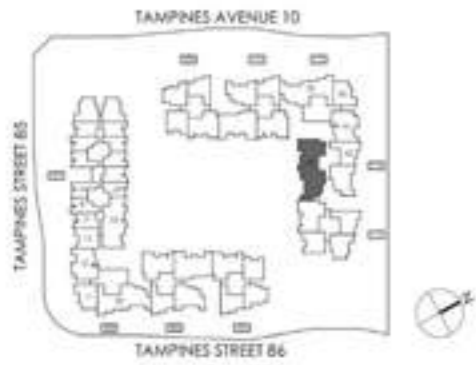

 Call 9048 0660 To Enquire More!